

Arch Handles

Aluminum

SPECIFICATION

Arch handle

Aluminum

Powder coated

- Black, RAL 9005, textured finish **SW**
- Silver, RAL 9006, textured finish **SR**

End pieces

Zinc die casting

Powder coated

Silver, RAL 9006, textured finish

Grub screws

Steel, property class 5.8

Zinc plated, blue passivated

Hex nuts ISO 4032-M8

Steel, zinc plated

Washers DIN 125

Steel, zinc plated



TECHNICAL INFORMATION

- Strength Values of Screws (see page)
- Load Rating Information (see page A35)

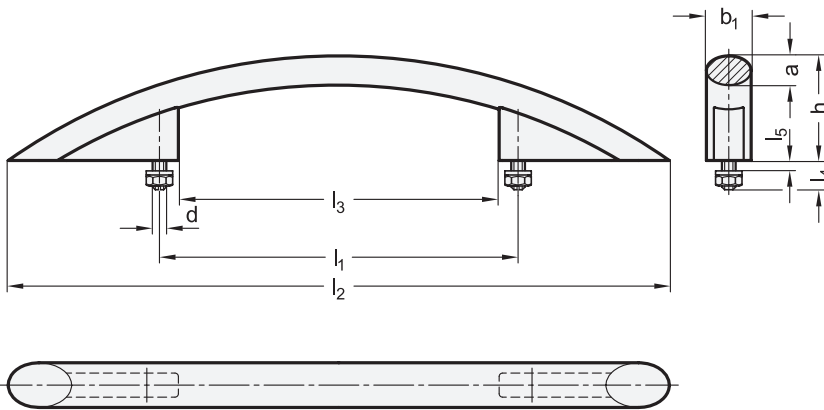

GN 665

Description	b ₁	l ₁ ± 0.25	a	b ₂	d	h-1	l ₂ ≈	l ₃	l ₄ ≈	l ₅ max.	⚖
GN 665-26-350-SW	26	350	17	14	M 8	69	526	328	18	9.5	650
GN 665-26-450-SW	26	450	17	14	M 8	69	632	428	18	9.5	700
GN 665-26-350-SR	26	350	17	14	M 8	69	526	328	18	9.5	600
GN 665-26-450-SR	26	450	17	14	M 8	69	632	428	18	9.5	685